



****AVAILABLE AUGUST 2026** **£130pppw****
****FURNISHED**** A fantastic ground floor flat on Hazelwood Avenue, West Jesmond. With an open plan reception and three double bedrooms, this apartment is a good size and is close to a choice of shops, bars & restaurants.

The property briefly comprises an entrance hall. A large open plan reception, with modern fitted kitchen and lounge area plus a wall mounted TV. There are three double bedrooms and also a bathroom WC. Externally there is a yard to the rear and on street permit parking to the front.

Available at £130 per person per week.

Available 28th August 2026 | £130pppw/
 £1,690pcm | Furnished | Ground Floor Flat |
 Three Double Bedrooms | 706 Sq. ft (65.6m²) |
 Open Plan Kitchen/ Lounge | Bathroom WC |
 Furnished | Rear Yard | Permit Parking | DG &
 GCH | Council Tax Band: B | EPC Rating: C



GROUND FLOOR
 709 sq.ft. (65.8 sq.m.) approx.

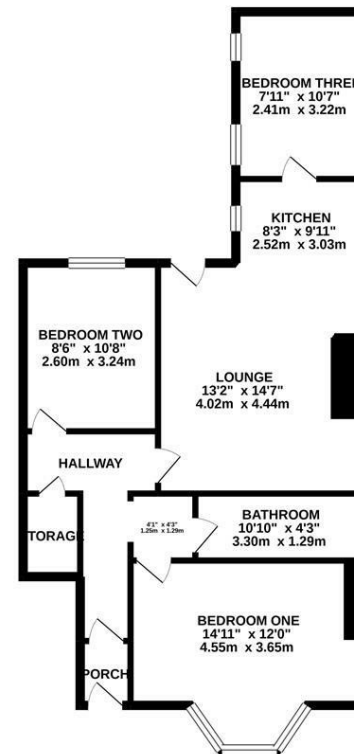

TOTAL FLOOR AREA : 709 sq.ft. (65.8 sq.m.) approx.

Whilst every attempt has been made to ensure the accuracy of the floorplan contained herein, measurements of doors, windows, rooms and any other items are approximate and no responsibility is taken for any error, omission or mis-statement. This plan is for illustrative purposes only and should be used as such by any prospective purchaser. The services, systems and appliances shown have not been tested and no guarantee as to their operability or efficiency can be given.
 Made with Metropix 1/2021

£1,690 PCM

IMPORTANT NOTE: These particulars and the descriptions and measurements herein do not constitute representation and whilst every effort has been made to ensure accuracy, this cannot be guaranteed.

